



MOVE INN ESTATES
MAKING THE RIGHT MOVE



Mill Farm Crescent
Whitton, Hounslow, TW4 5PJ
Price Guide £525,000



Floor Plan

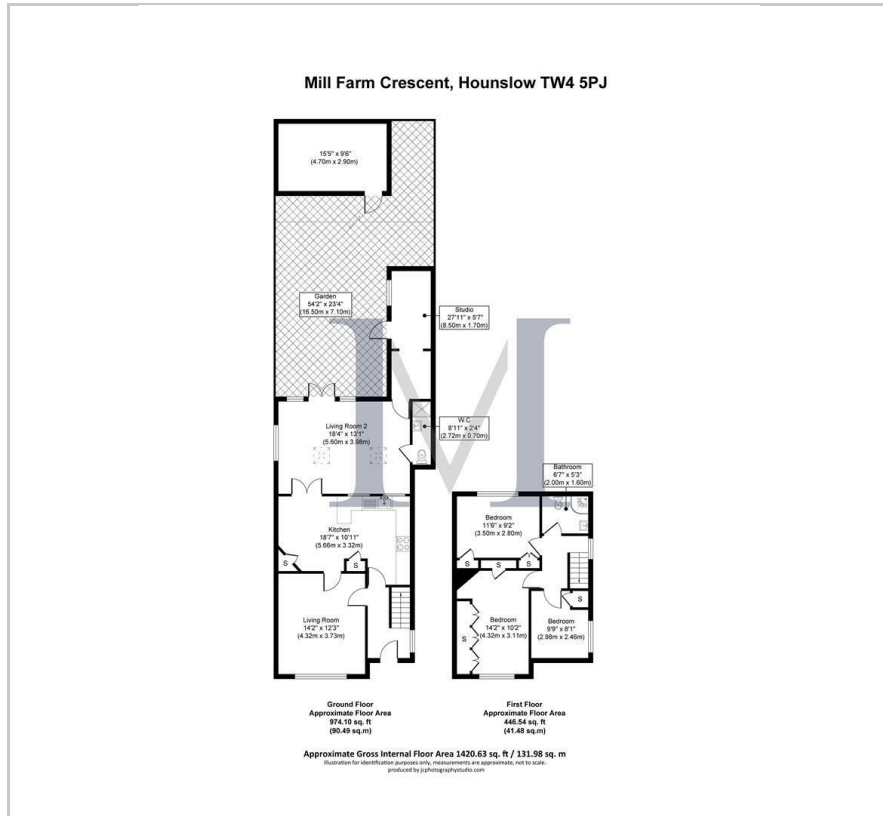

Area Map



Energy Efficiency Graph

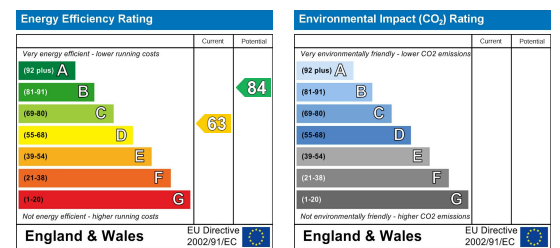

Viewing

Please contact our Move Inn Estates - Sales Office on 0208 574 4966 if you wish to arrange a viewing appointment for this property or require further information.

- Three bedrooms
- End terrace
- Extended
- Modern throughout
- Driveway
- Outbuilding

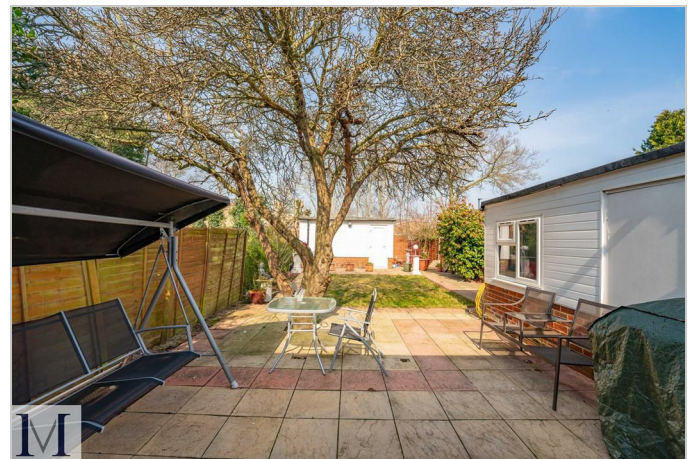

An opportunity to acquire this bright and spacious extended, three bedroom end terraced family home in the Richmond Borough.

The property to the ground floor offers a great feeling of space with two separate reception rooms, contemporary fitted kitchen/dining area and the added benefit of a downstairs shower room with WC.

To the first floor are three generously sized bedrooms, two doubles and a further single, and a family bathroom suite.

Further benefits to the property include off-street parking, double glazed windows, gas central heating and a good sized rear garden with an outbuilding which could be used as a study/storage area. This property offers further scope for extension (STPP).

The property is located within easy walking distance to local shops, local bus routes, Crane Park and many other local amenities. The property also falls within the catchment area for many highly rated Richmond borough schools.

Viewings highly recommended.



These particulars, whilst believed to be accurate are set out as a general outline only for guidance and do not constitute any part of an offer or contract. Intending purchasers should not rely on them as statements of representation of fact, but must satisfy themselves by inspection or otherwise as to their accuracy. No person in this firm's employment has the authority to make or give any representation or warranty in respect of the property.

46 Vicarage Farm Road, Hounslow, Middlesex, TW5 0AB

Tel: 0208 574 4966 Email: info@moveinnestates.co.uk www.moveinnestates.co.uk